

**BUILDING ENVELOPE AMENDED**

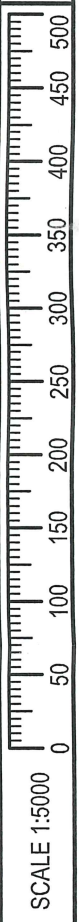
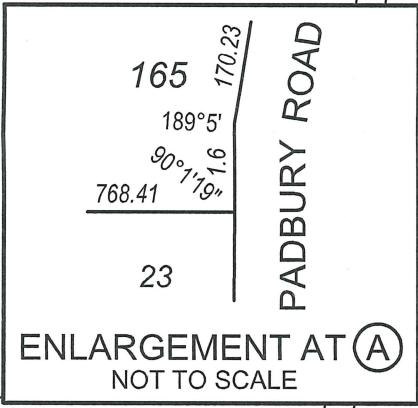

GERALDTON CENTRAL, Suite 2  
 66 Chapman Road, GERALDTON WA 6530  
 PO Box 695, GERALDTON WA 6531  
 Email: [info@quantumsurveys.com.au](mailto:info@quantumsurveys.com.au)  
 PHONE: (08) 9965 0077  
 FAX: (08) 9965 0088

LAND • ENGINEERING • MINING

CLIENT **WRJ & SF STICKNEY & MJ LUNDY**  
 TITLE **BUILDING ENVELOPE LOCATIONS  
 LOTS 165 - 170 PADBURY ROAD,  
 BOOKARA**

SURVEYED	DATE
COMPUTED	
DRAWN S. D'MELLO	18/10/2012
JOB No. 9051	SCALE 1:5000 @ A3
HORIZONTAL DATUM J.C.G. 94	VERTICAL DATUM
FIELD BOOK	LEVEL BOOK

THIS DRAWING REMAINS THE PROPERTY OF QUANTUM SURVEYS AND SHALL NOT BE USED OR COPIED WITHOUT PERMISSION. THIS DRAWING SHALL BE CONSIDERED PRELIMINARY ONLY UNTIL SIGNED AS APPROVED.

CHECKED		APPROVED	
---------	--	----------	--

DRAWING No. **9051BE01**

Building Envelope P1145 – Lot 165 (#161) Padbury Road, Bookara

